

**WINDOW FLASHING SYSTEM  
INSTALLATION INSTRUCTIONS**

**FOR**

**PUNCHED WINDOW OPENINGS  
WITH LOOSE STEEL LINTELS**

Offered By:

**EXO-TEC Manufacturing, Inc.**

**22 Washington Street**

**Stoughton, MA 02072**

**( 781 ) 344-9794**

**Fax ( 781 ) 344-9823**

**<http://www.exo-tec.biz>**

**E-Mail: [len@exo-tec.biz](mailto:len@exo-tec.biz)**

1.) INSTALL THE WATER, AIR  
OR AIR / VAPOR BARRIER  
TO VICINITY OF THE  
WINDOW SILL HEIGHT.

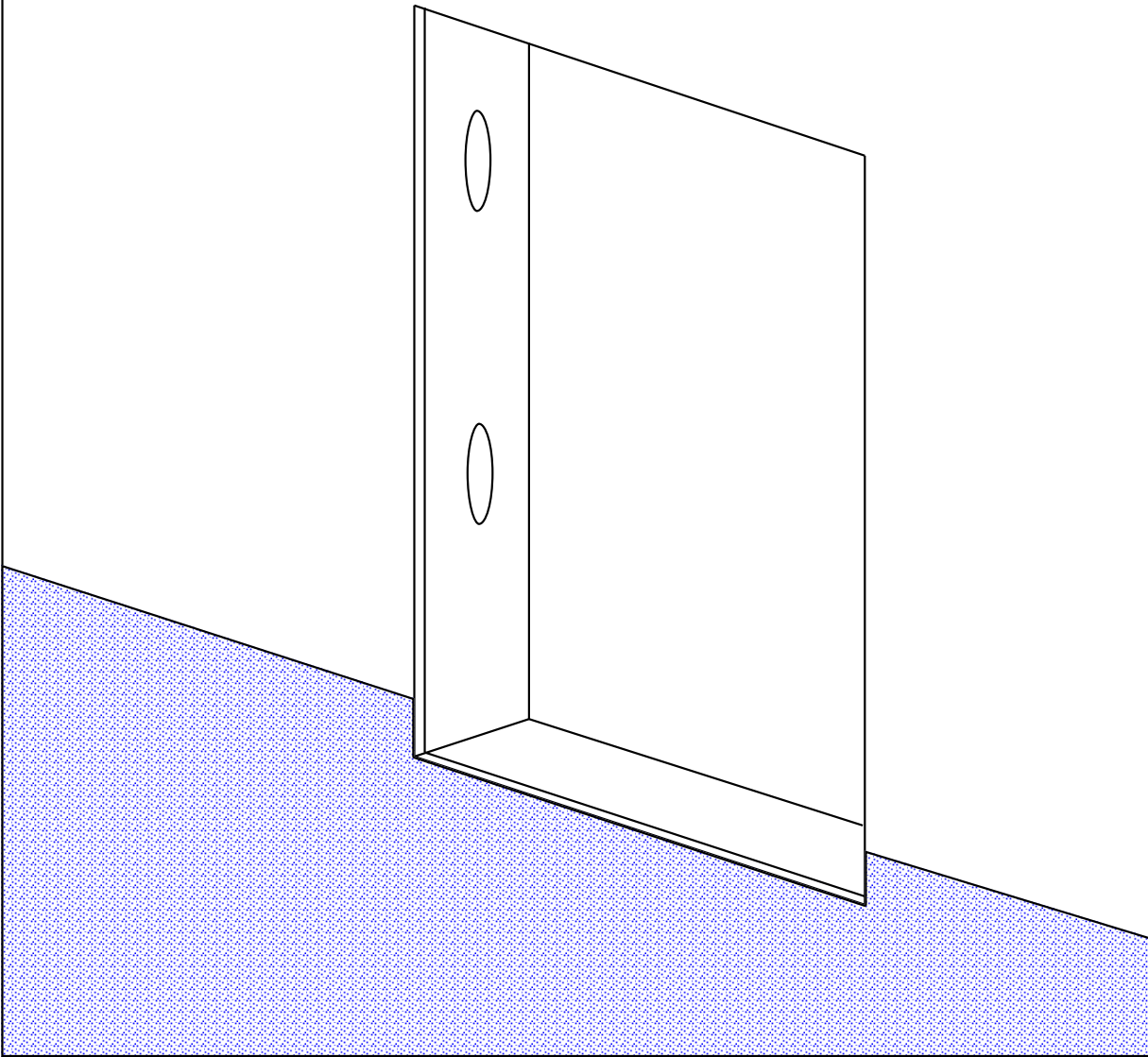

**EXO-TEC MANUFACTURING, INC.**

294 PLEASANT ST. SUITE 203A, STOUGHTON, MA 02072

( 781 ) 344-9794 FAX ( 781 ) 344-9823

[www.exo-tec.biz](http://www.exo-tec.biz)

WINDOW FLASHING SYSTEM INSTALLATION: STEP 1

2.) INSTALL HYLOAD WINDOW  
SILL CORNER CLOAKS IN A FULL  
BED OR WITH A CONTINUOUS  
PERIMETER BEAD OF HYLOAD  
ADHESIVE.

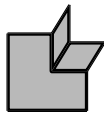

HYLOAD WINDOW  
SILL CORNER  
CLOAK ISO

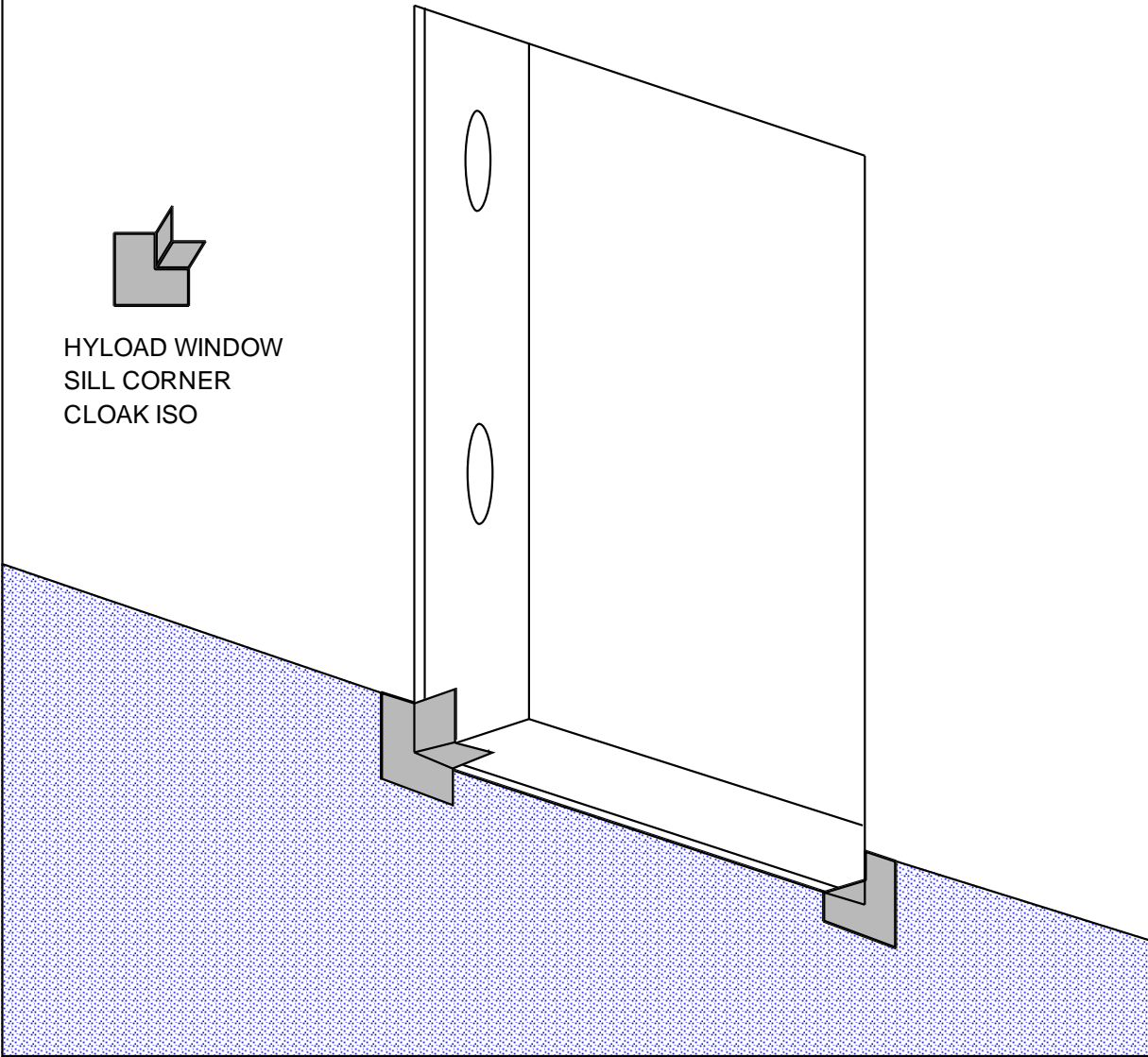

**EXO-TEC MANUFACTURING, INC.**

294 PLEASANT ST. SUITE 203A , STOUGHTON, MA 02072

( 781 ) 344-9794 FAX ( 781 ) 344-9823

[www.exo-tec.com](http://www.exo-tec.com)

WINDOW FLASHING SYSTEM INSTALLATION: STEP 2

3.) **INSTALL HYLOAD S/A FLASHING WITH DRIP EDGE AT THE WINDOW SILL WITH THE INNER EDGE OF THE DRIP EDGE AT THE APPROXIMATE LOCATION OF THE BACK EDGE OF THE WINDOW.**

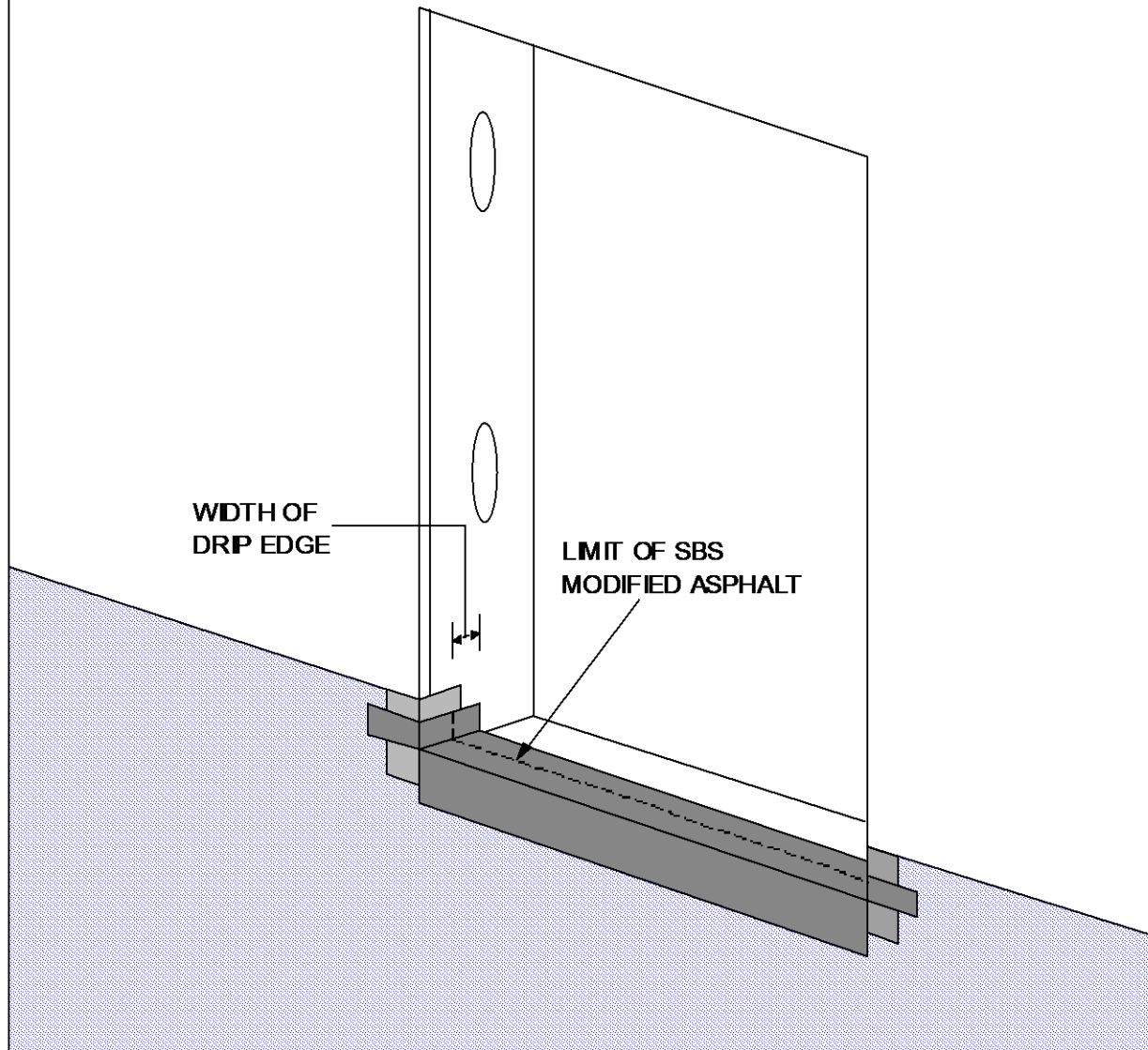

**EXO-TEC MANUFACTURING, INC.**  
294 PLEASANT ST. SUITE 203A, STOUGHTON, MA 02072

(781) 344-9794 FAX (781) 344-9823  
[www.exo-tec.biz](http://www.exo-tec.biz)

**WINDOW FLASHING SYSTEM INSTALLATION: STEP 3**

4.) **INSTALL JAMFLASH® BY SEATING IT TIGHTLY TO THE JAMB AND SHEATHING THEN FASTENING IT WITH CORROSION RESISTANT, PANCAKE HEAD, SELF-TAPPING SCREWS AT 12" O.C. ON BOTH FASTENING LEGS**

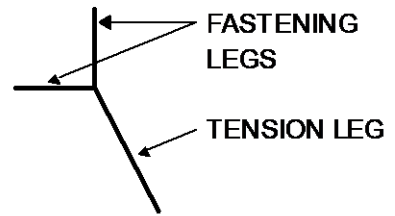

JAMFLASH TOP VIEW

NOTE: SEE CROSS SECTION AT JAMB 1 SKETCH

INSTALL THE JAMFLASH® +/- 1/4" DOWN FROM THE TOP OF THE ROUGH OPENING

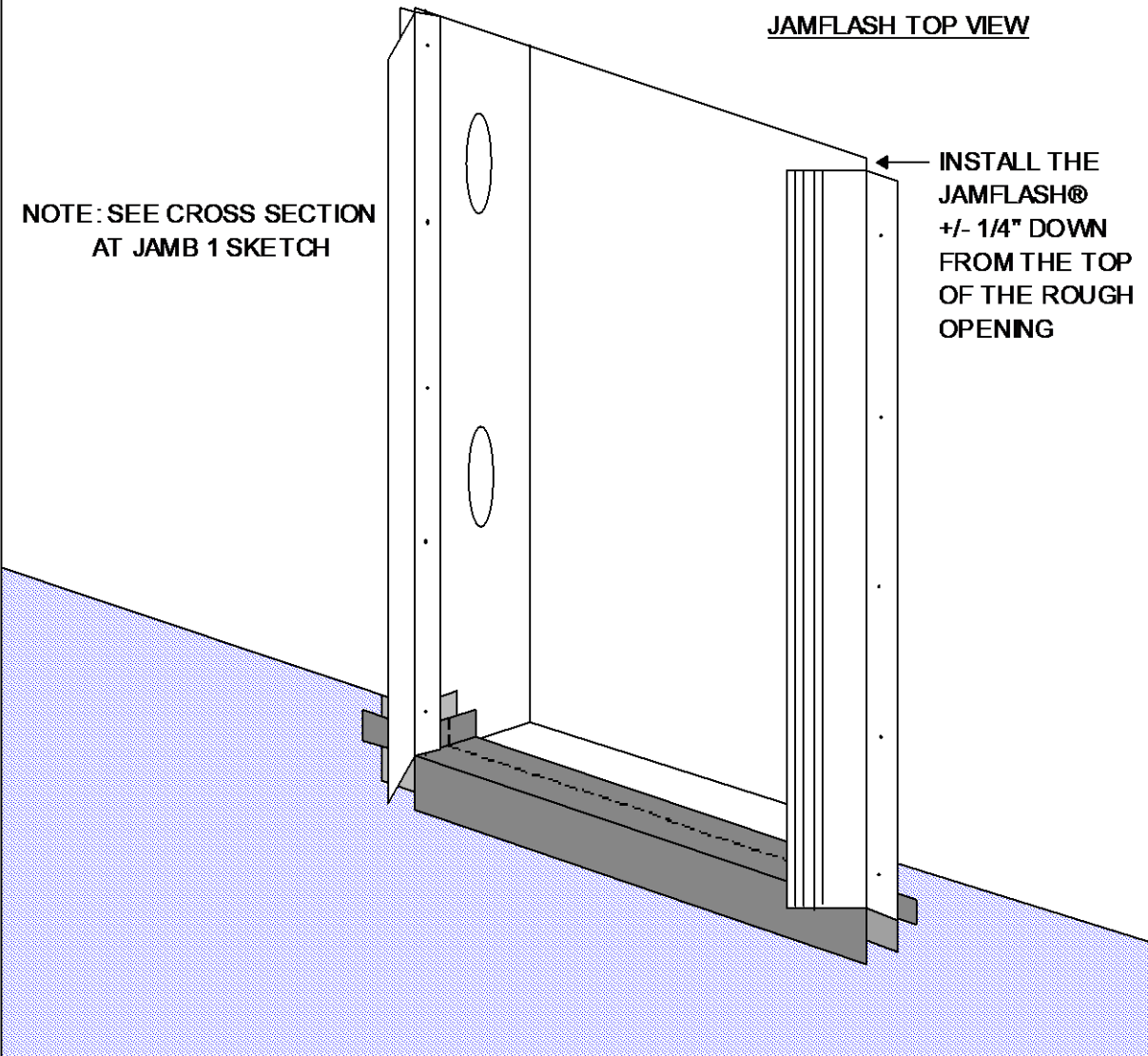

**EXO-TEC MANUFACTURING, INC.**

294 PLEASANT ST. SUITE 203A, STOUGHTON, MA 02072

( 781 ) 344-9794 FAX ( 781 ) 344-9823

[www.exo-tec.biz](http://www.exo-tec.biz)

**WINDOW FLASHING SYSTEM INSTALLATION: STEP 4**

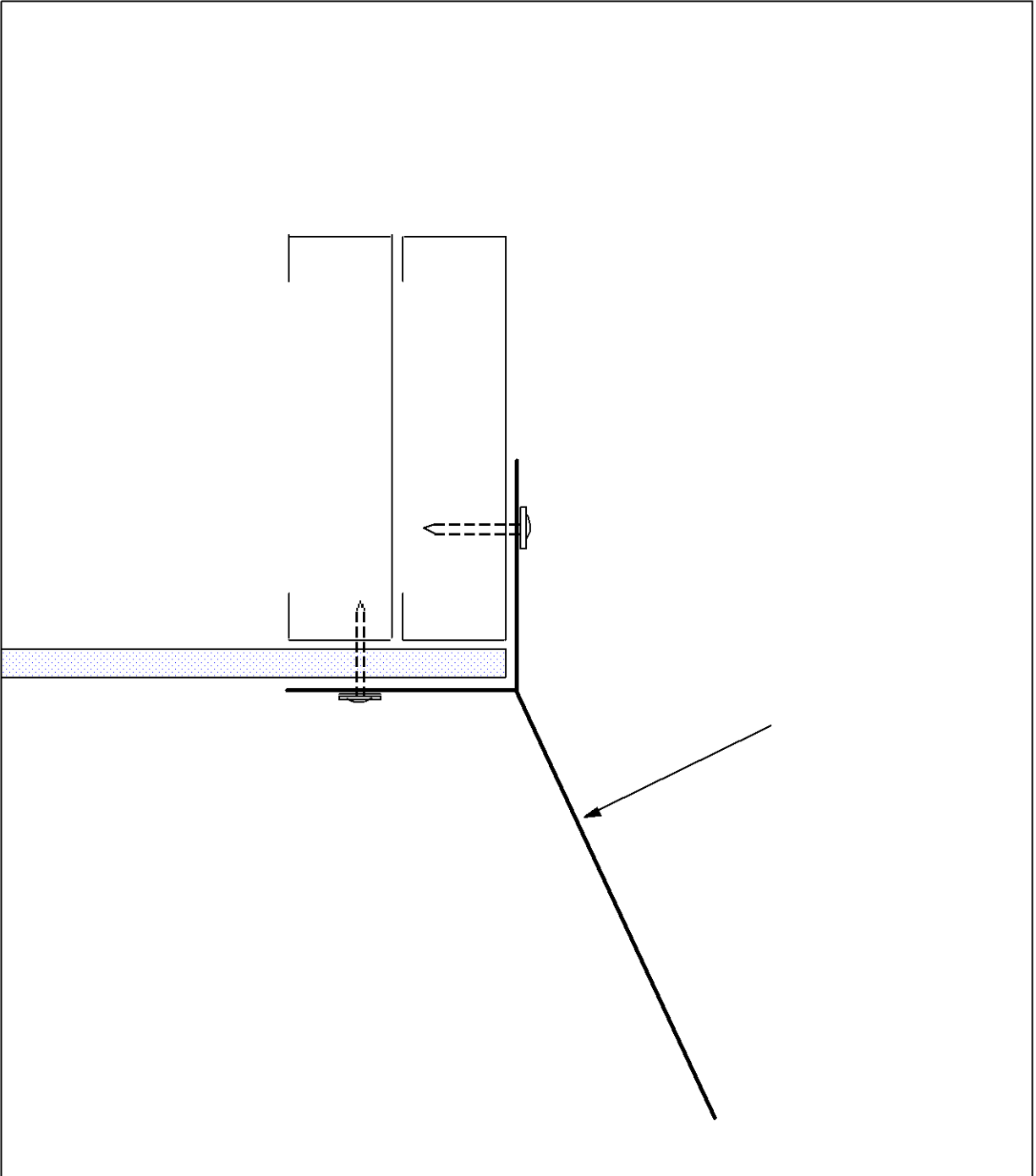

**EXO-TEC MANUFACTURING, INC.**

294 PLEASANT ST. SUITE 203A, STOUGHTON, MA 02072

( 781 ) 344-9794 FAX ( 781 ) 344-9823

[www.exo-tec.biz](http://www.exo-tec.biz)

**WINDOW FLASHING SYSTEM INSTALLATION: SECTION AT JAMB 1**

5.) INSTALL THE WATER, AIR OR AIR / VAPOR BARRIER UP AND OVER THE WINDOW. LAP OVER THE CAVITY FACE FASTENING LEG OF THE JAMFLASH.

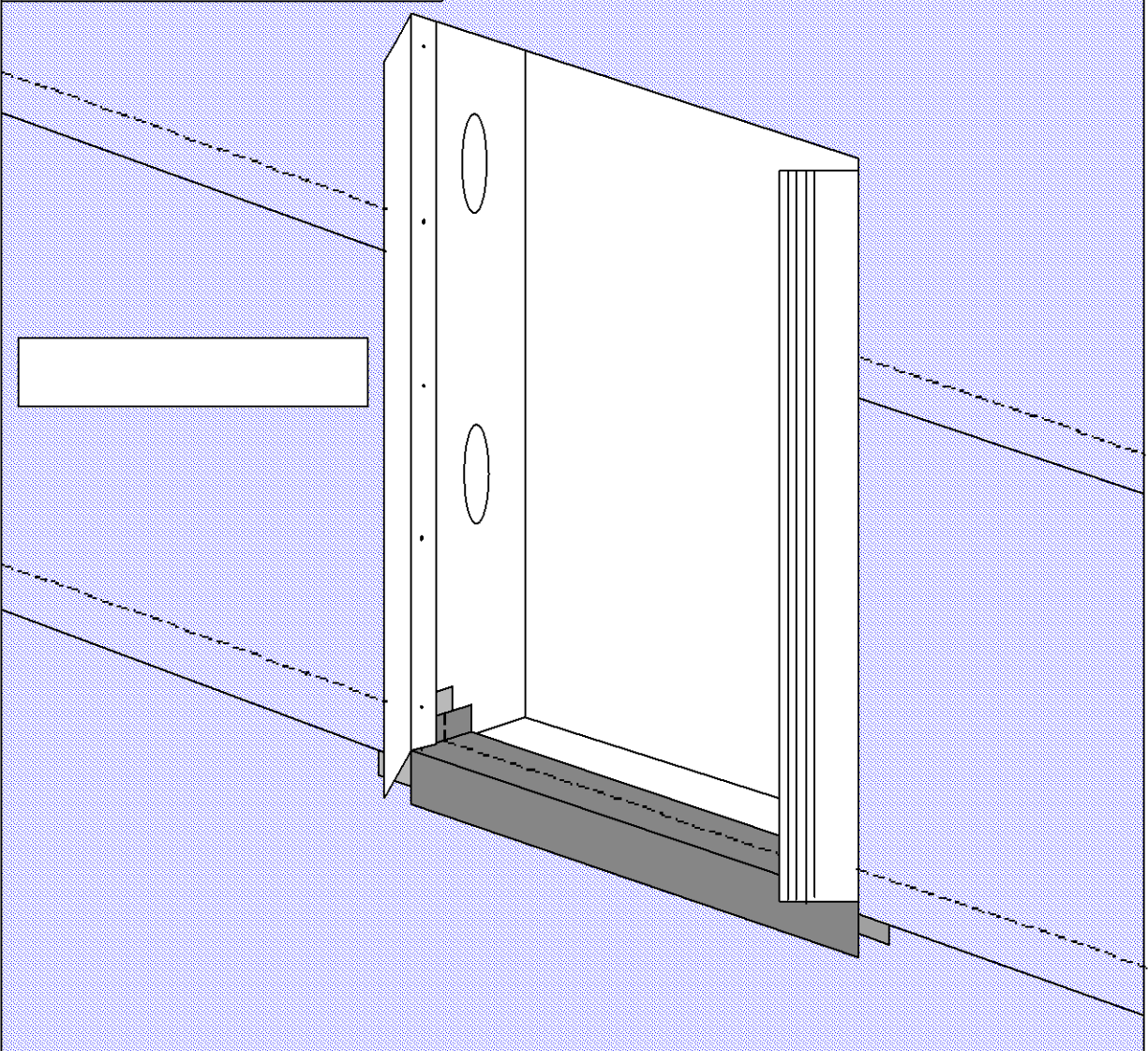

**EXO-TEC MANUFACTURING, INC.**

294 PLEASANT ST. SUITE 203A, STOUGHTON, MA 02072

( 781 ) 344-9794 FAX ( 781 ) 344-9823

[www.exo-tec.biz](http://www.exo-tec.biz)

**WINDOW FLASHING SYSTEM INSTALLATION: STEP 5**

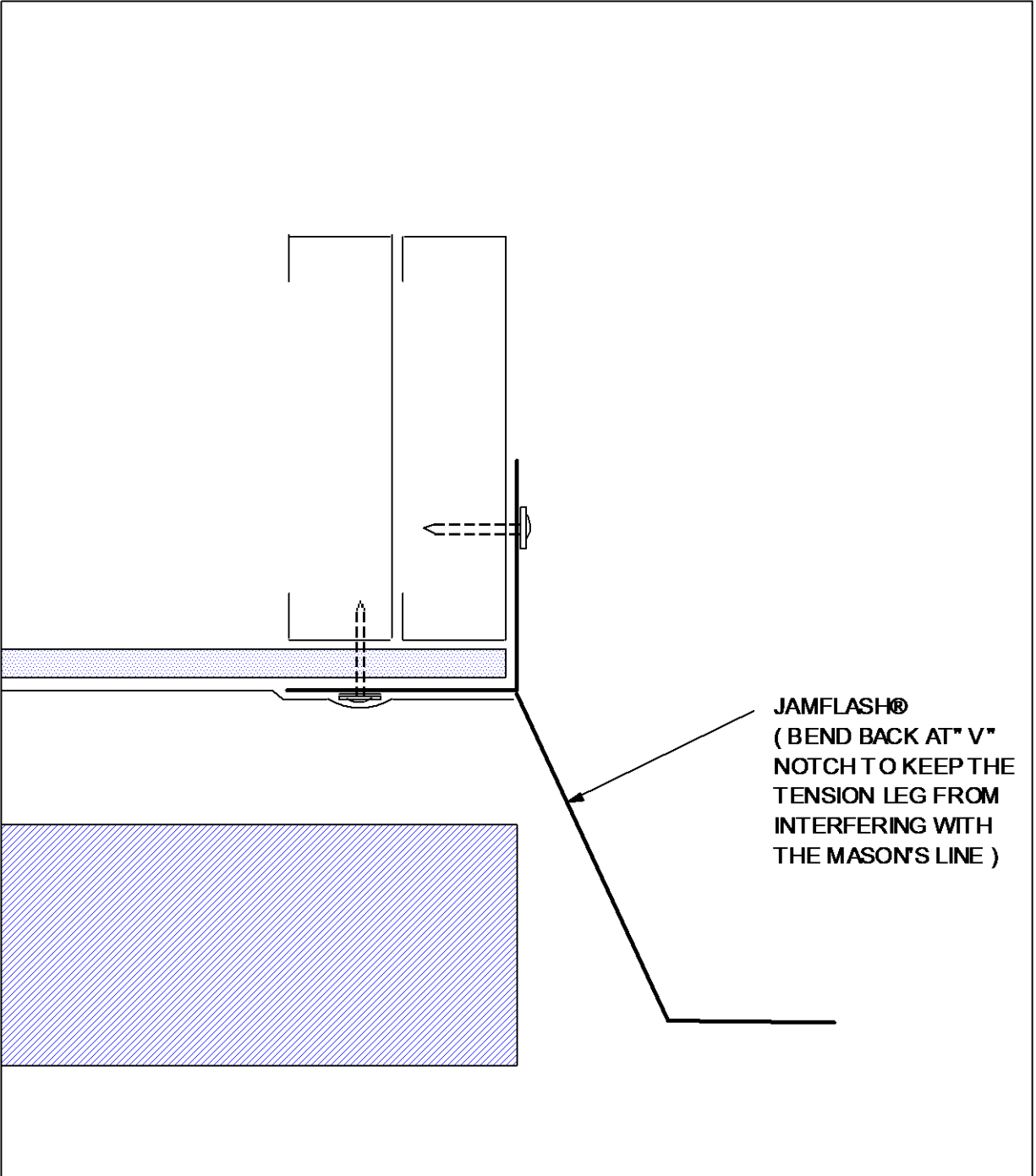

**EXO-TEC MANUFACTURING, INC.**

294 PLEASANT ST. SUITE 203A, STOUGHTON, MA 02072

( 781 ) 344-9794 FAX ( 781 ) 344-9823

[www.EXO-TEC.BIZ](http://www.EXO-TEC.BIZ)

**WINDOW FLASHING SYSTEM INSTALLATION: STEP 6**



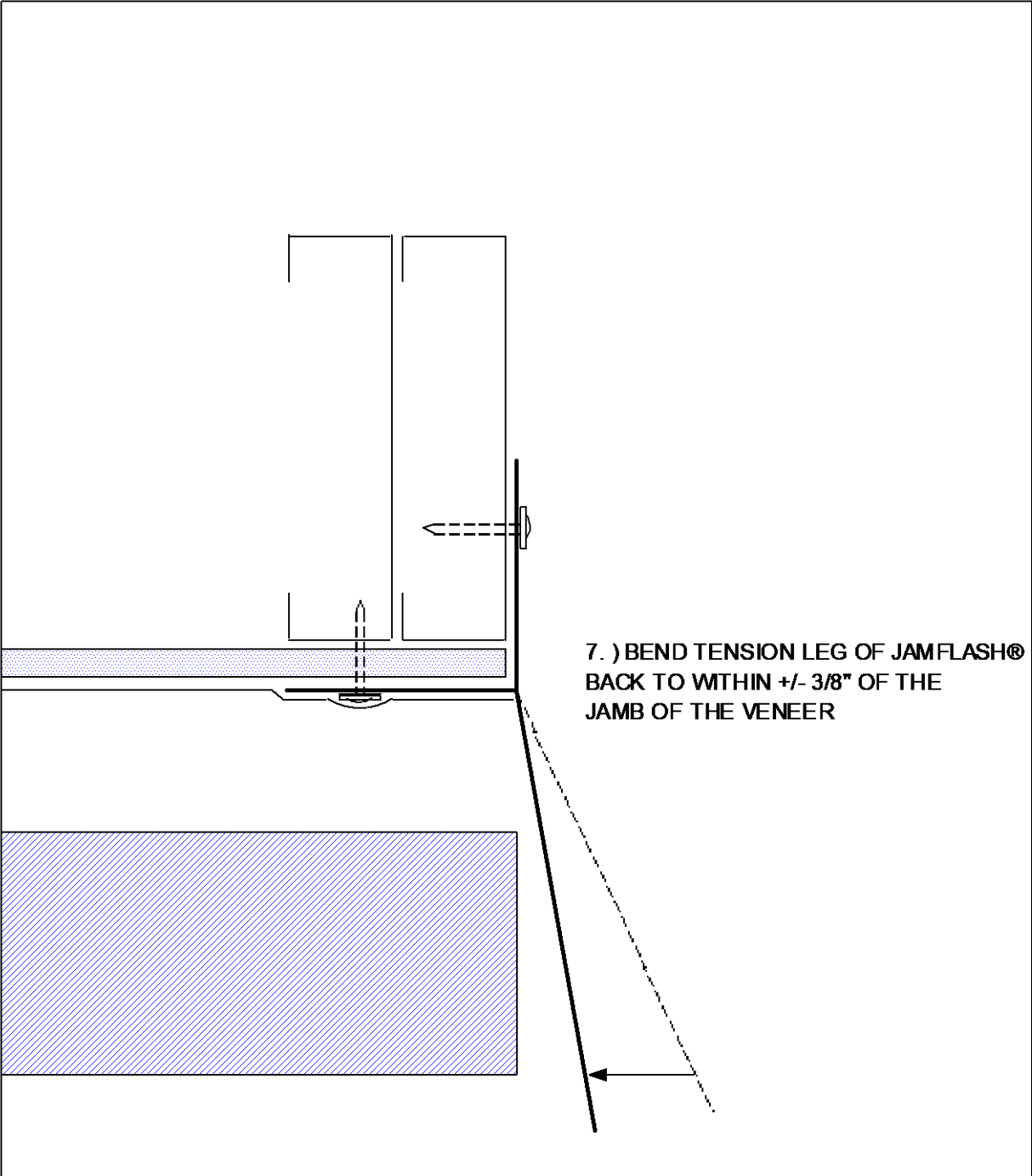

7.) BEND TENSION LEG OF JAMFLASH®  
BACK TO WITHIN +/- 3/8" OF THE  
JAMB OF THE VENEER

**EXO-TEC MANUFACTURING, INC.**

294 PLEASANT ST. SUITE 203A, STOUGHTON, MA 02072

( 781 ) 344-9794 FAX ( 781 ) 344-9823

[www.exo-tec.biz](http://www.exo-tec.biz)

**WINDOW FLASHING SYSTEM INSTALLATION: STEP 7**

8.) APPLY A 6" WIDE STRIP OF HYLOAD SELF ADHERING MEMBRANE FLASHING TO THE JUNCTION OF THE JAMFLASH® AND THE LOOSE LINTEL AT THE HEAD OF THE OPENING. RELEASE THE PRESSURE ON THE JAMFLASH® TO ALLOW IT TO SPRING BACK TO ITS NATURAL SHAPE. A "BELLOW" WILL OCCUR IN THE HYLOAD FLASHING MEMBRANE AT THE 1/4" GAP BETWEEN THE TOP OF THE FLASHING AND BOTTOM OF THE LINTEL.

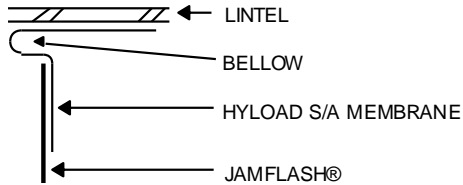

**BELLOW DETAIL**

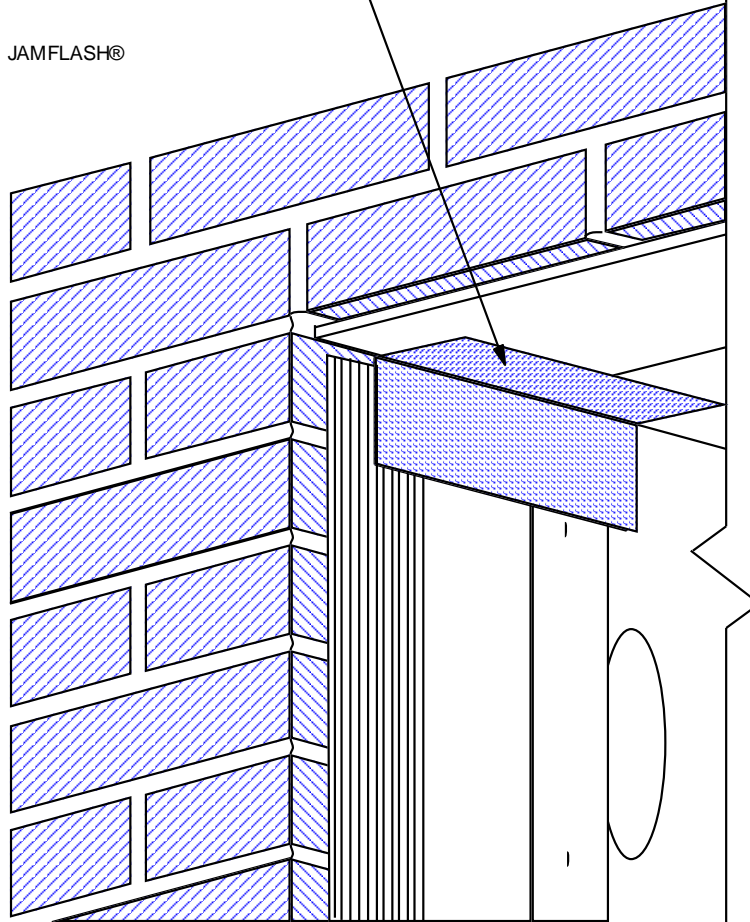

**EXO-TEC MANUFACTURING, INC.**

294 PLEASANT ST. SUITE 203A STOUGHTON, MA 02072

( 781 ) 344-9794 FAX ( 718 ) 344-9823

[www.exo-tec.biz](http://www.exo-tec.biz)

WINDOW FLASHING INSTALLATION: STEP 8

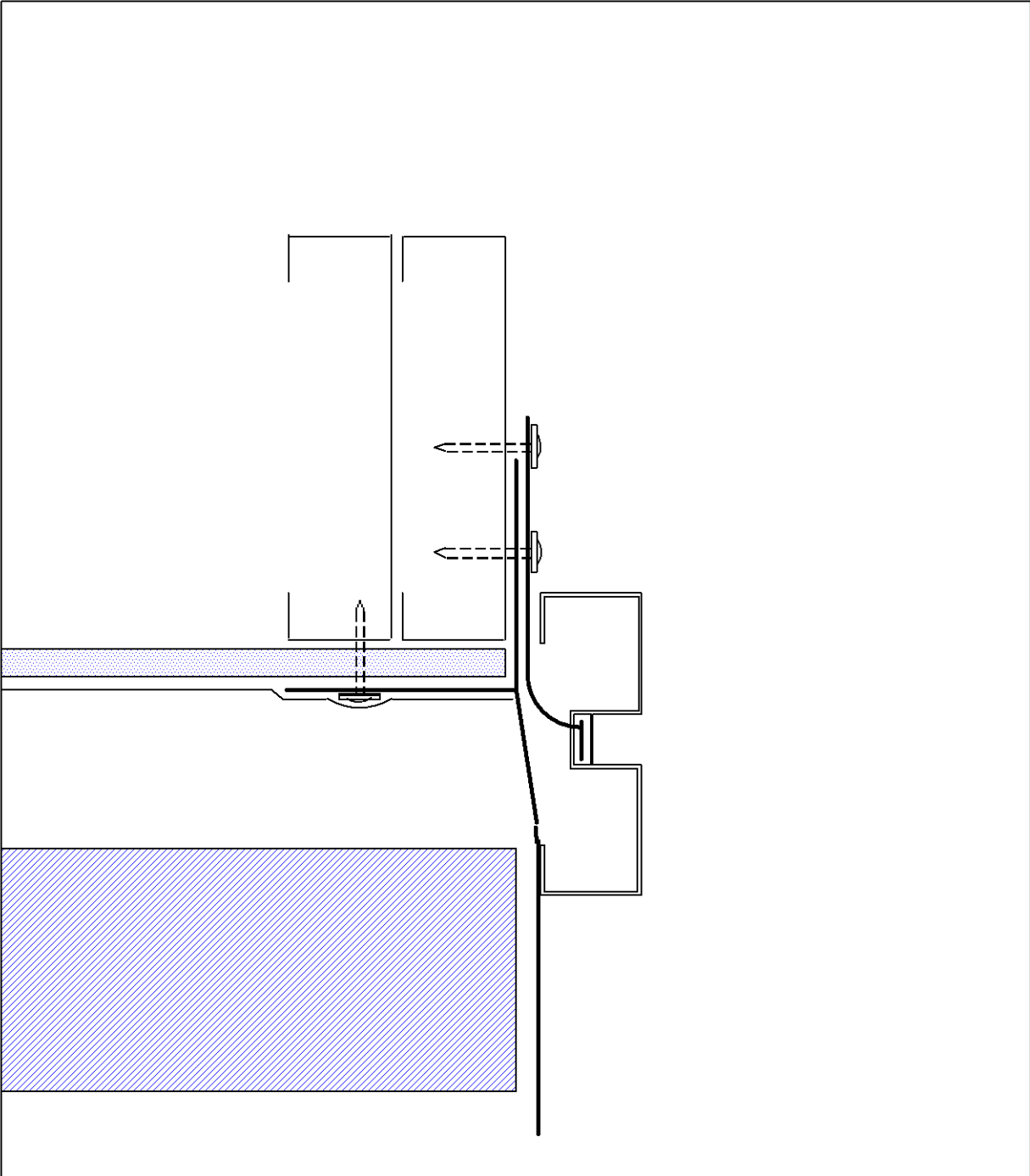

**EXO-TEC MANUFACTURING, INC.**  
294 PLEASANT ST. SUITE 203A, STOUGHTON, MA 02072

( 781 ) 344-9794 FAX ( 781 ) 344-9823  
[www.exo-tec.biz](http://www.exo-tec.biz)

**WINDOW FLASHING SYSTEM INSTALLATION: STEP 9**

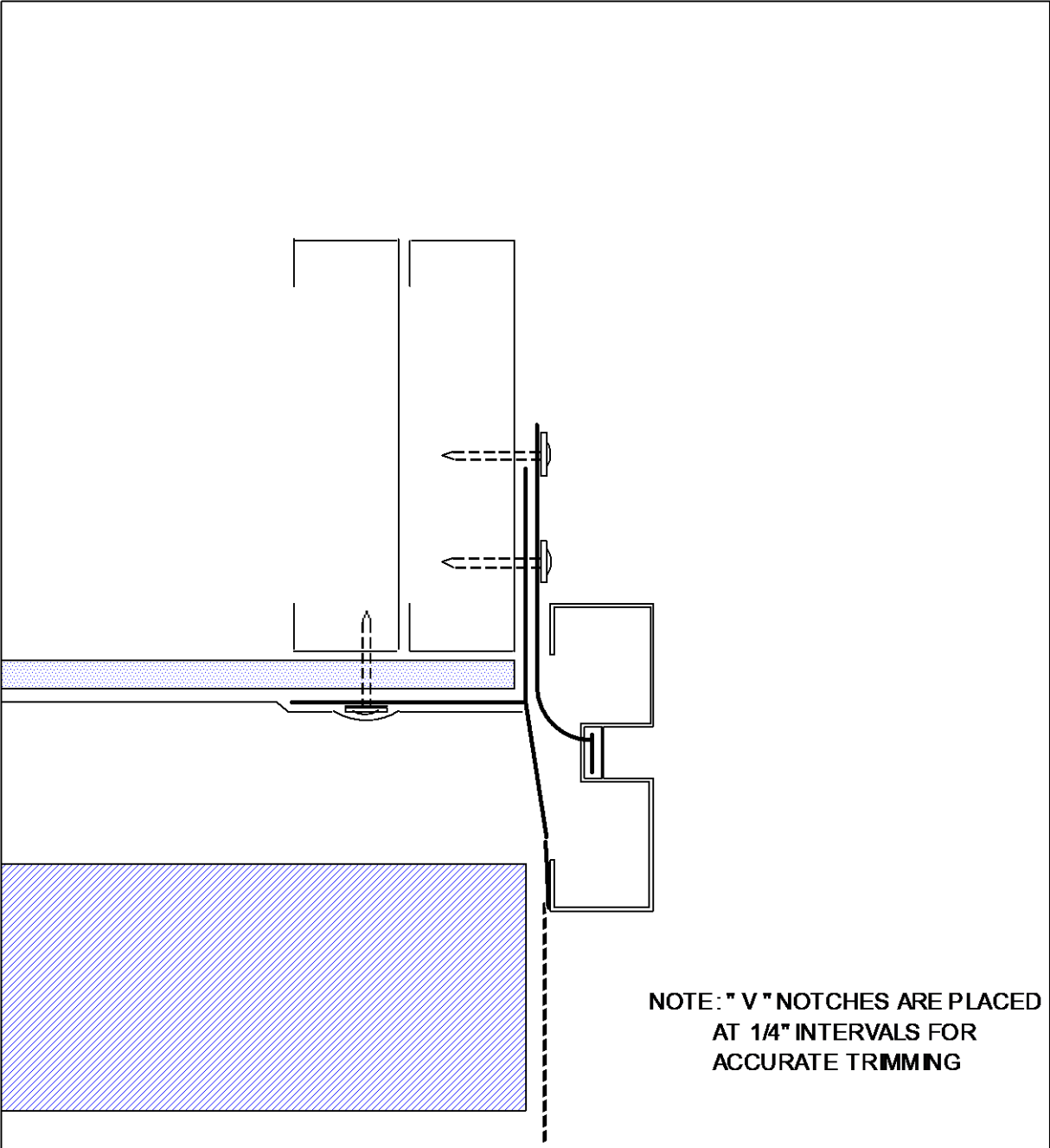

NOTE: " V " NOTCHES ARE PLACED  
AT 1/4" INTERVALS FOR  
ACCURATE TRIMMING

**EXO-TEC MANUFACTURING, INC.**  
294 PLEASANT ST. SUITE 203A, STOUGHTON, MA 02072

( 781 ) 344-9794 FAX ( 781 ) 344-9823  
[www.exo-tec.biz](http://www.exo-tec.biz)

**WINDOW FLASHING SYSTEM INSTALLATION: STEP 10**

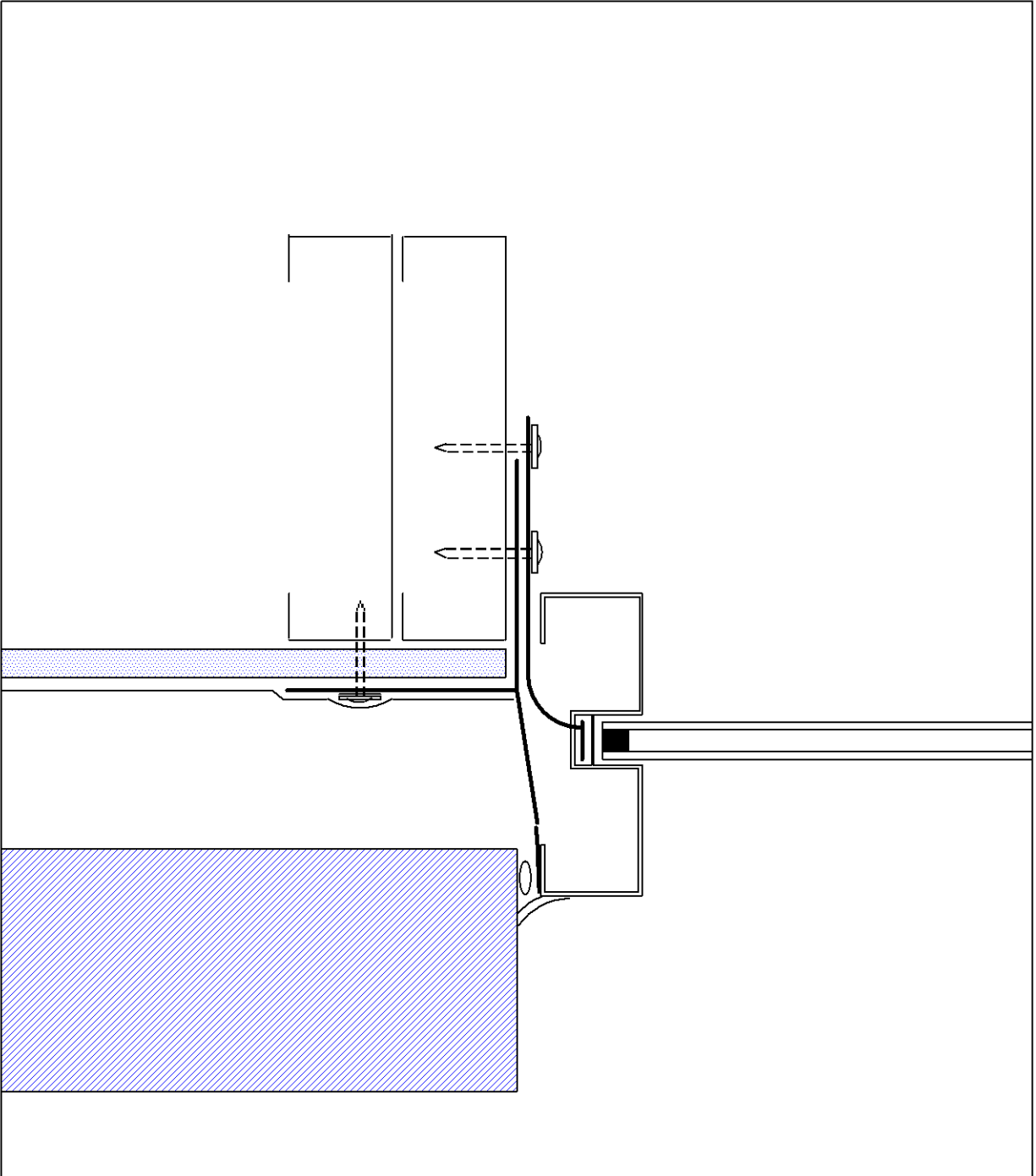

**EXO-TEC MANUFACTURING, INC.**  
294 PLEASANT ST. SUITE 203A, STOUGHTON, MA 02072

( 781 ) 344-9794 FAX ( 781 ) 344-9823  
[www.exo-tec.biz](http://www.exo-tec.biz)

**WINDOW FLASHING SYSTEM INSTALLATION: STEP 11**

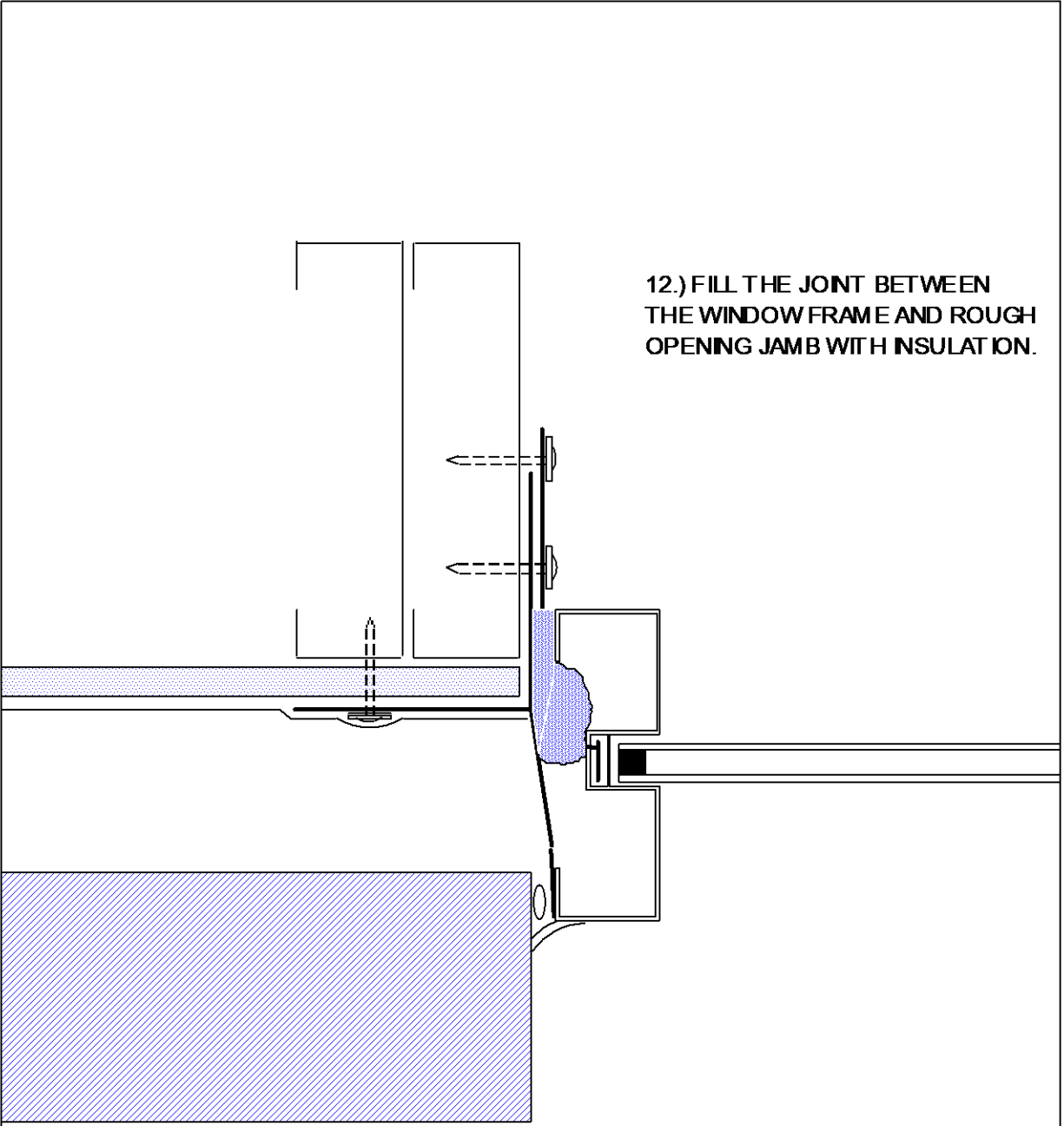

12.) FILL THE JOINT BETWEEN THE WINDOW FRAME AND ROUGH OPENING JAMB WITH INSULATION.

**EXO-TEC MANUFACTURING, INC.**  
294 PLEASANT ST. SUITE 203A, STOUGHTON, MA 02072

(781) 344-9794 FAX (781) 344-9823  
[www.exo-tec.biz](http://www.exo-tec.biz)

**WINDOW FLASHING SYSTEM INSTALLATION: STEP 12**

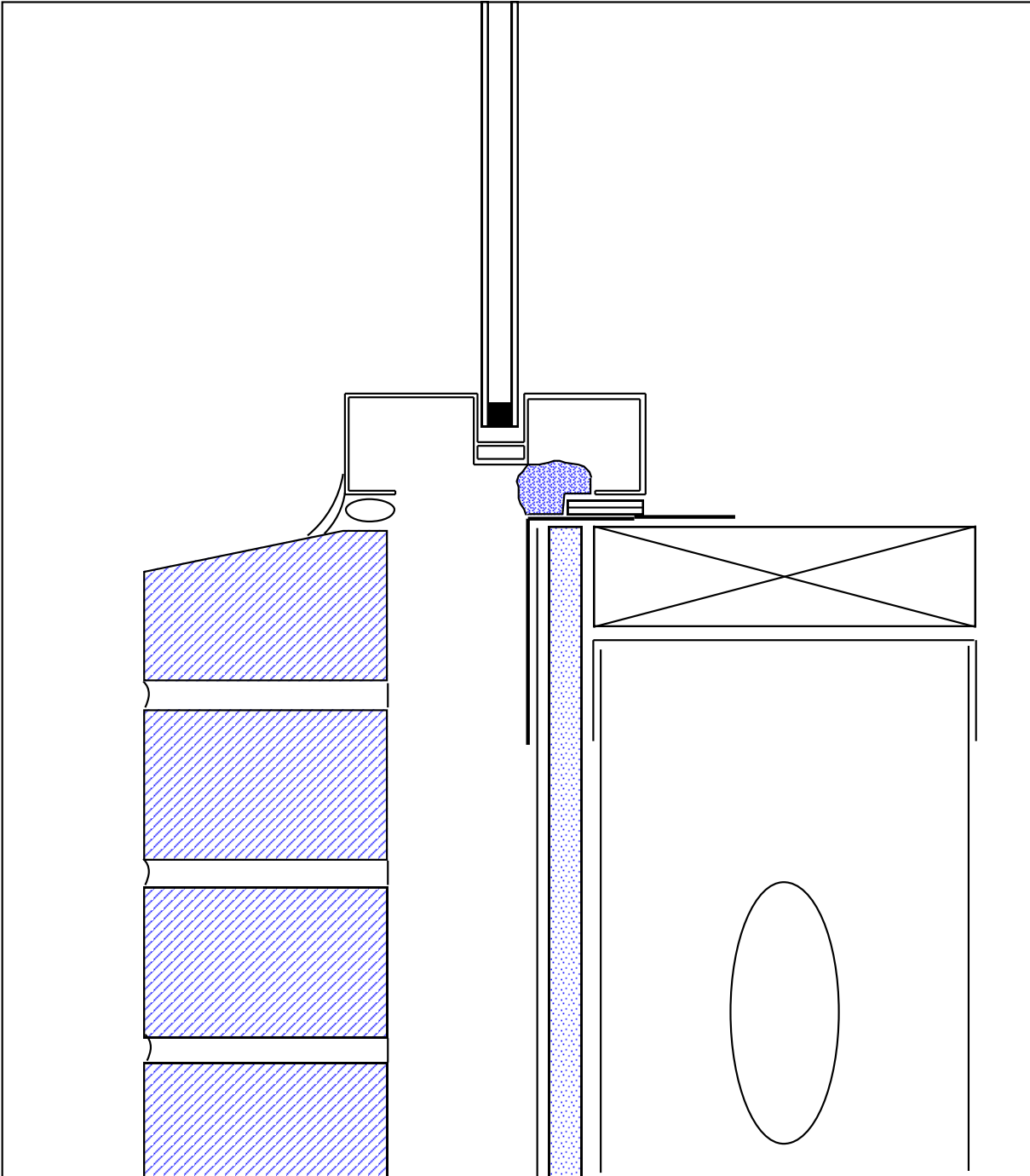

**EXO-TEC MANUFACTURING, INC.**

294 PLEASANT ST. SUITE 203A, STOUGHTON, MA 02072

( 781 ) 344-9794 FAX ( 781 ) 344-9823

[www.exo-tec.biz](http://www.exo-tec.biz)

WINDOW FLASHING SYSTEM INSTALLATION: STEP 13

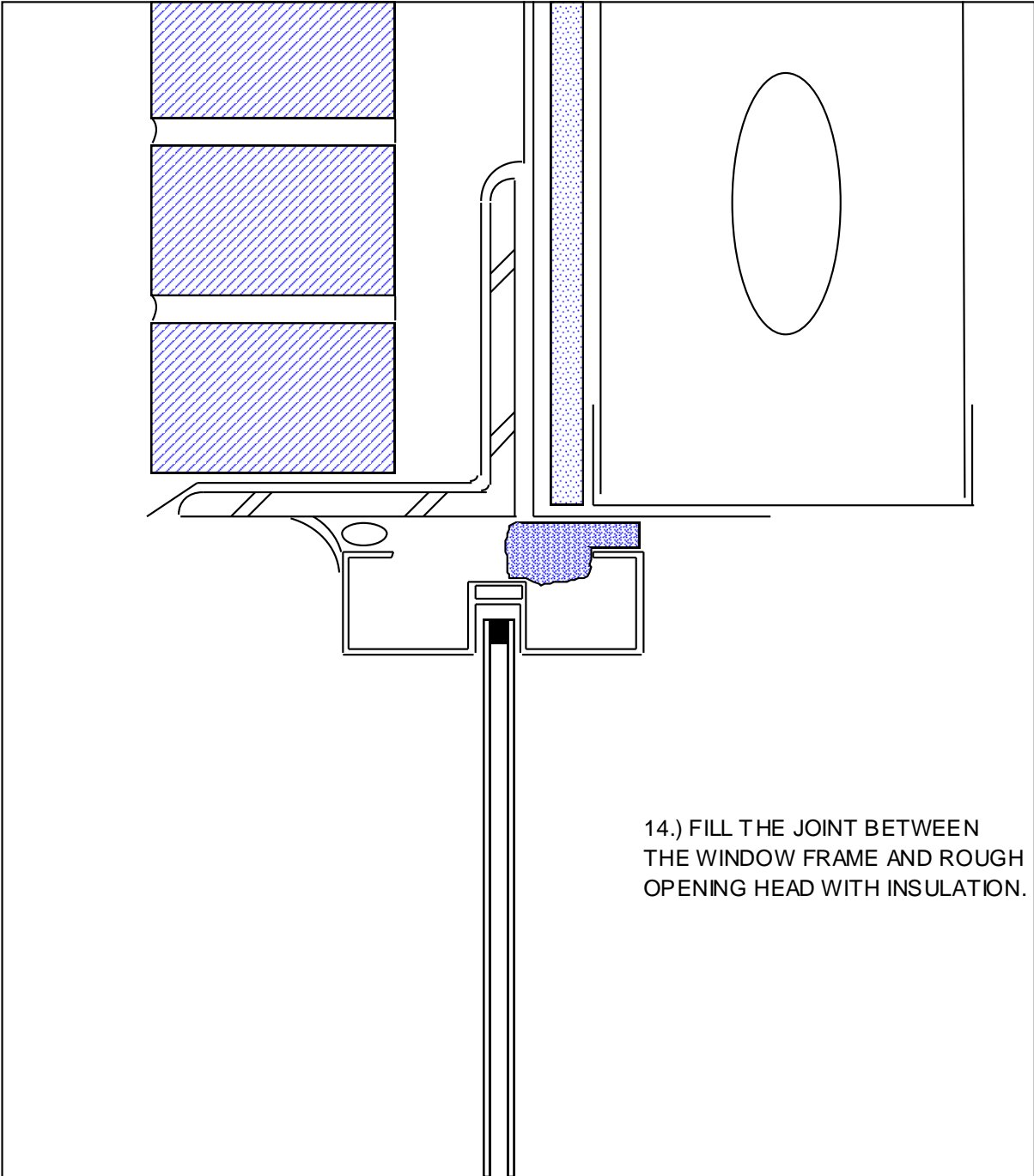

14.) FILL THE JOINT BETWEEN  
THE WINDOW FRAME AND ROUGH  
OPENING HEAD WITH INSULATION.

**EXO-TEC MANUFACTURING, INC.**

294 PLEASANT ST. SUITE 203A, STOUGHTON, MA 02072

( 781 ) 344-9794 FAX ( 781 ) 344-9823

[www.exo-tec.biz](http://www.exo-tec.biz)

WINDOW FLASHING SYSTEM INSTALLATION: STEP 14



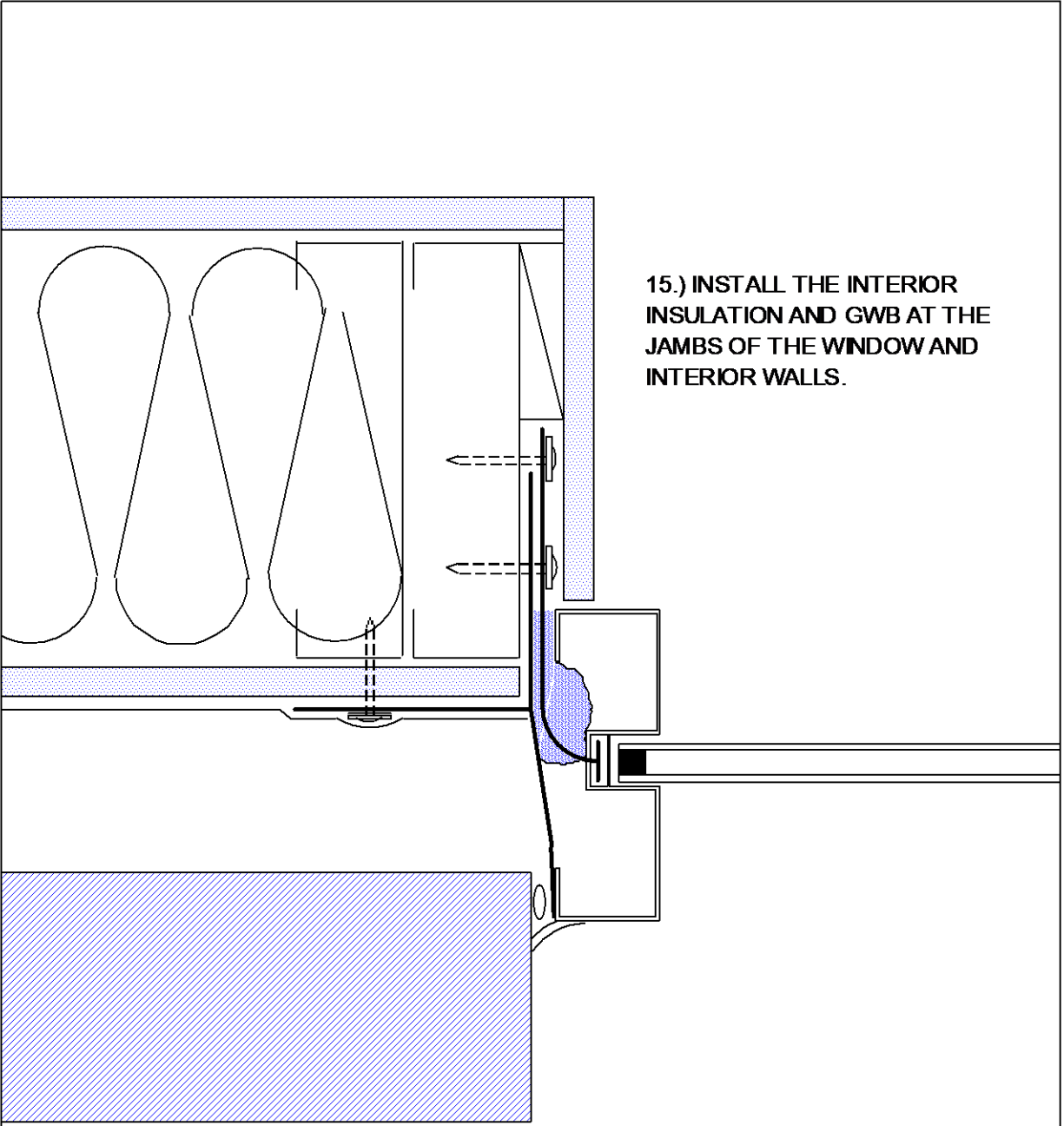

15.) INSTALL THE INTERIOR INSULATION AND GWB AT THE JAMBS OF THE WINDOW AND INTERIOR WALLS.

**EXO-TEC MANUFACTURING, INC.**  
294 PLEASANT ST. SUITE 203A, STOUGHTON, MA 02072

( 781 ) 344-9794 FAX ( 781 ) 344-9823  
[www.exo-tec.biz](http://www.exo-tec.biz)

**WINDOW FLASHING SYSTEM INSTALLATION: STEP 15**

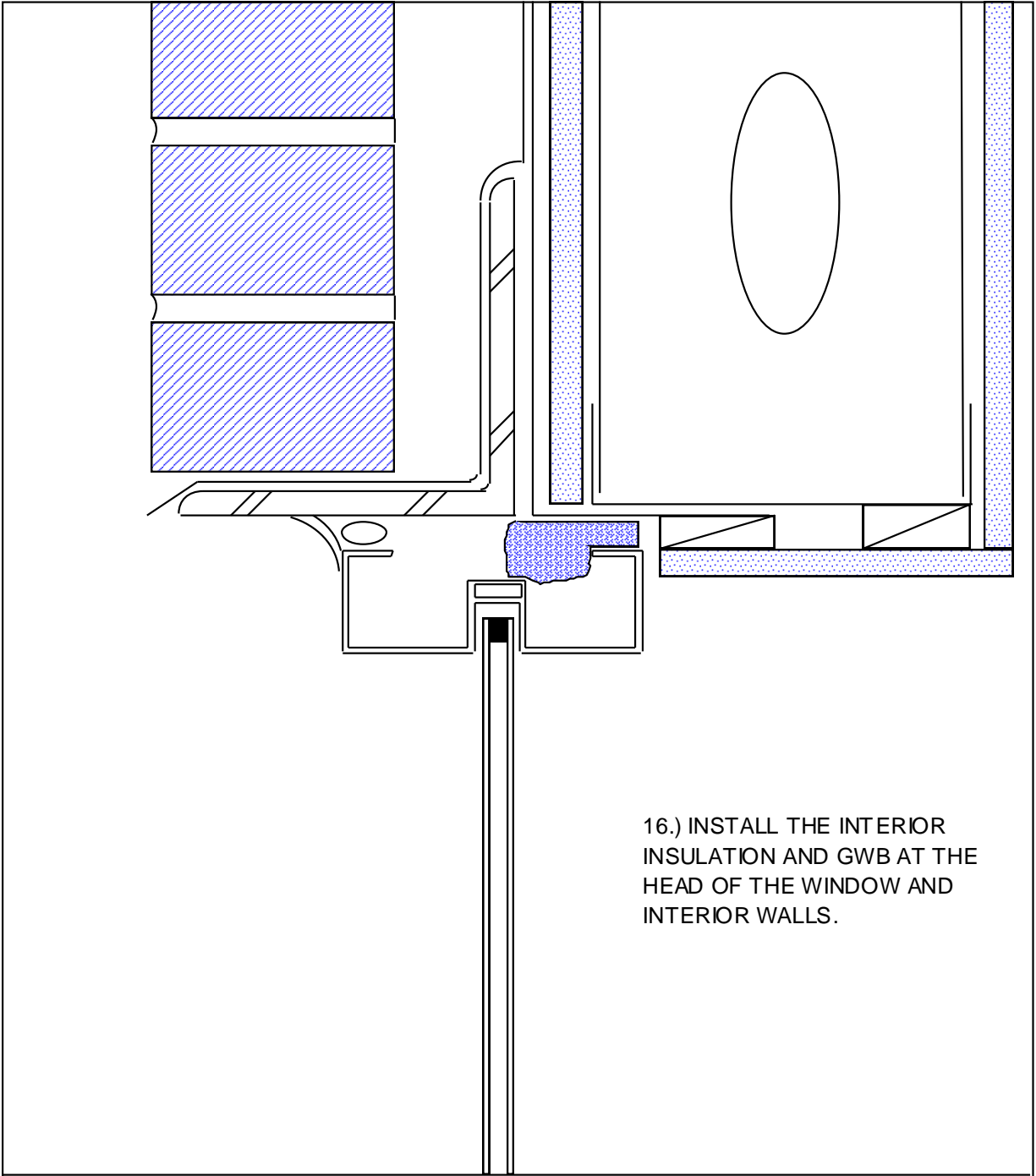

16.) INSTALL THE INTERIOR INSULATION AND GWB AT THE HEAD OF THE WINDOW AND INTERIOR WALLS.

**EXO-TEC MANUFACTURING, INC.**  
294 PLEASANT ST. SUITE 203A, STOUGHTON, MA 02072

( 781 ) 344-9794 FAX ( 781 ) 344-9823  
[www.exo-tec.biz](http://www.exo-tec.biz)

WINDOW FLASHING SYSTEM INSTALLATION: STEP 16

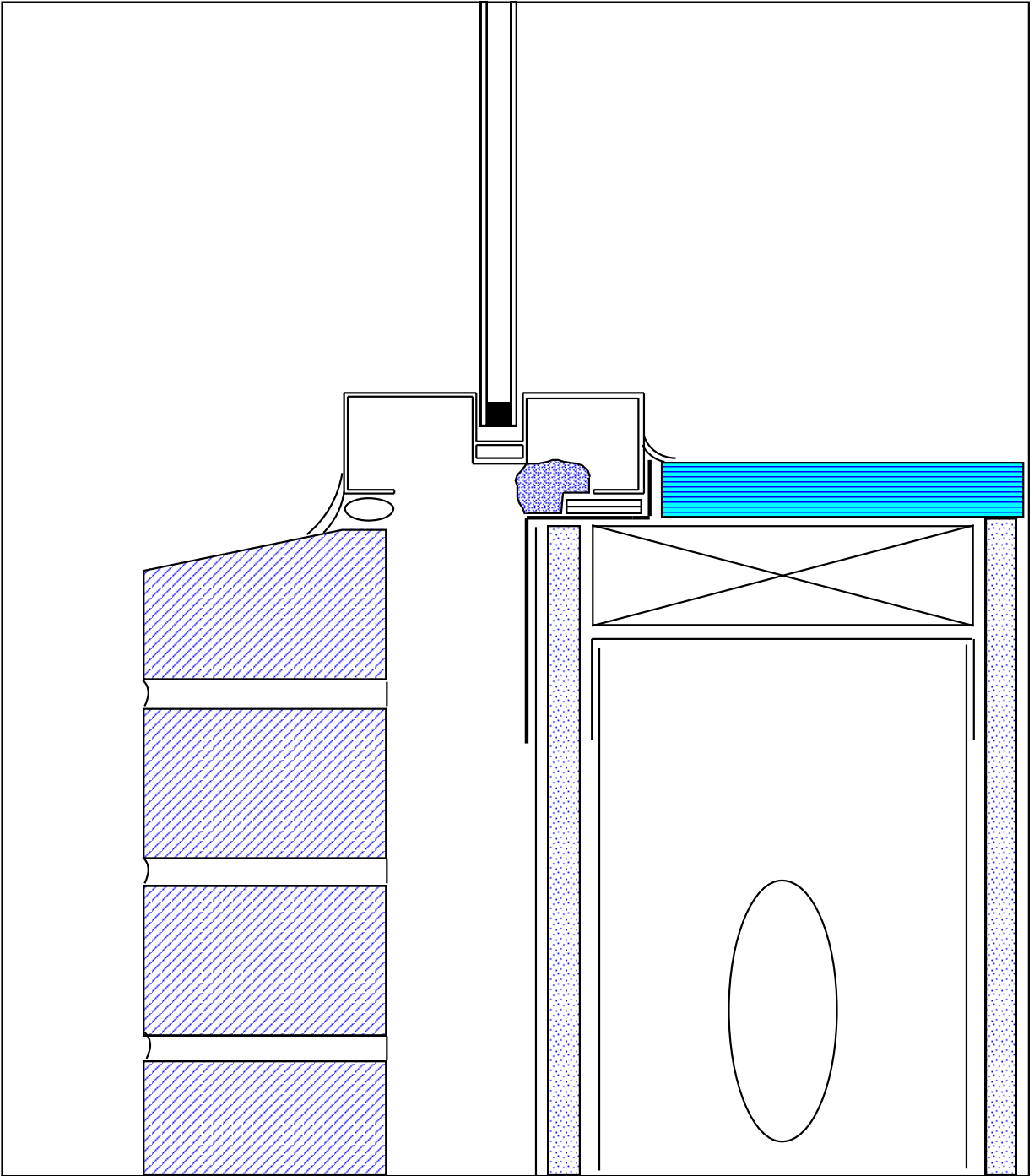

**EXO-TEC MANUFACTURING, INC.**

294 PLEASANT ST. SUITE 203A, STOUGHTON, MA 02072

( 781 ) 344-9794 FAX ( 781 ) 344-9823

[www.exo-tec.biz](http://www.exo-tec.biz)

WINDOW FLASHING SYSTEM INSTALLATION: STEP 17

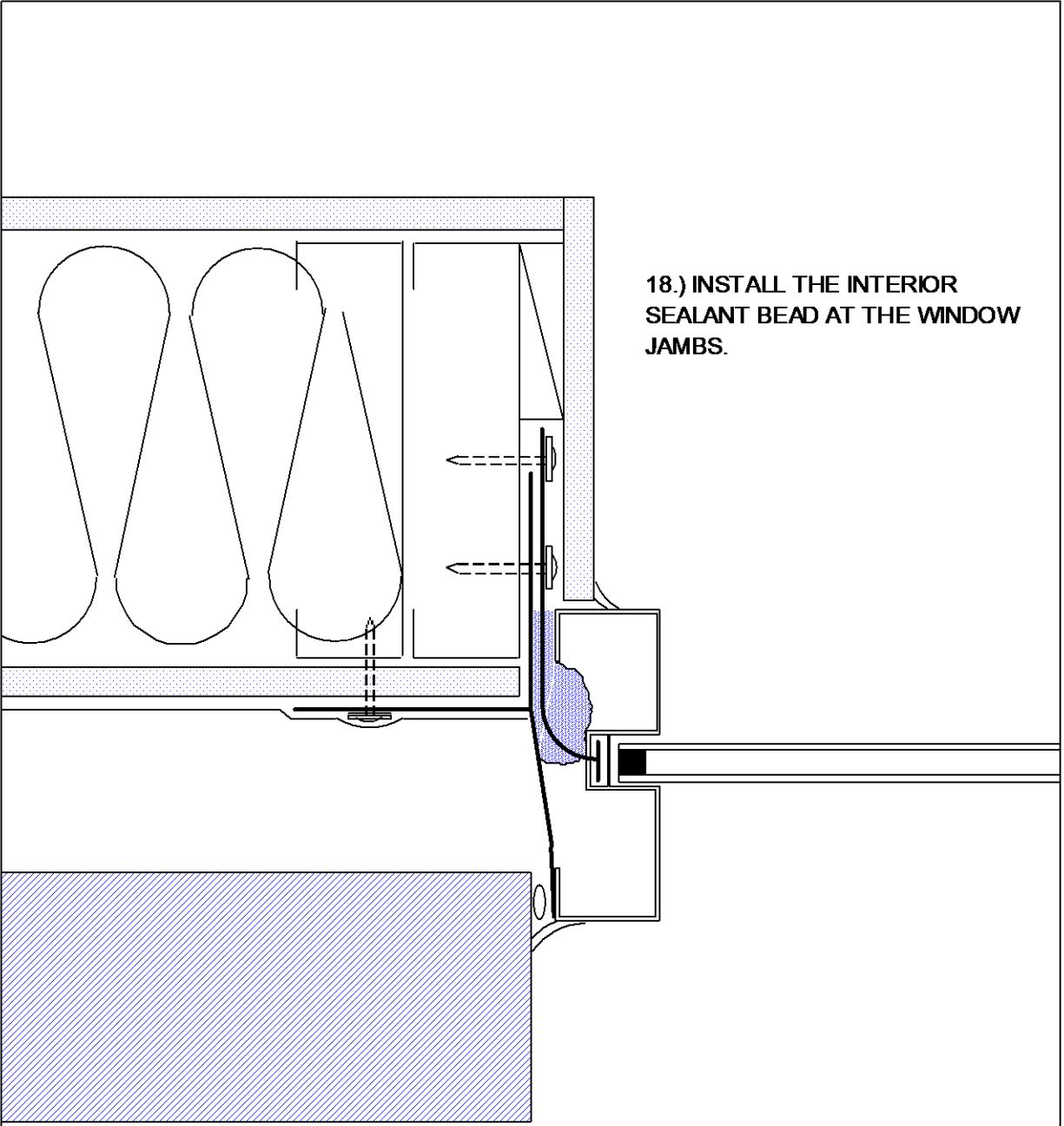

18.) INSTALL THE INTERIOR  
SEALANT BEAD AT THE WINDOW  
JAMBS.

**EXO-TEC MANUFACTURING, INC.**

294 PLEASANT ST. SUITE 203A, STOUGHTON, MA 02072

( 781 ) 344-9794 FAX ( 781 ) 344-9823

[www.exo-tec.biz](http://www.exo-tec.biz)

**WINDOW FLASHING SYSTEM INSTALLATION: STEP 18**

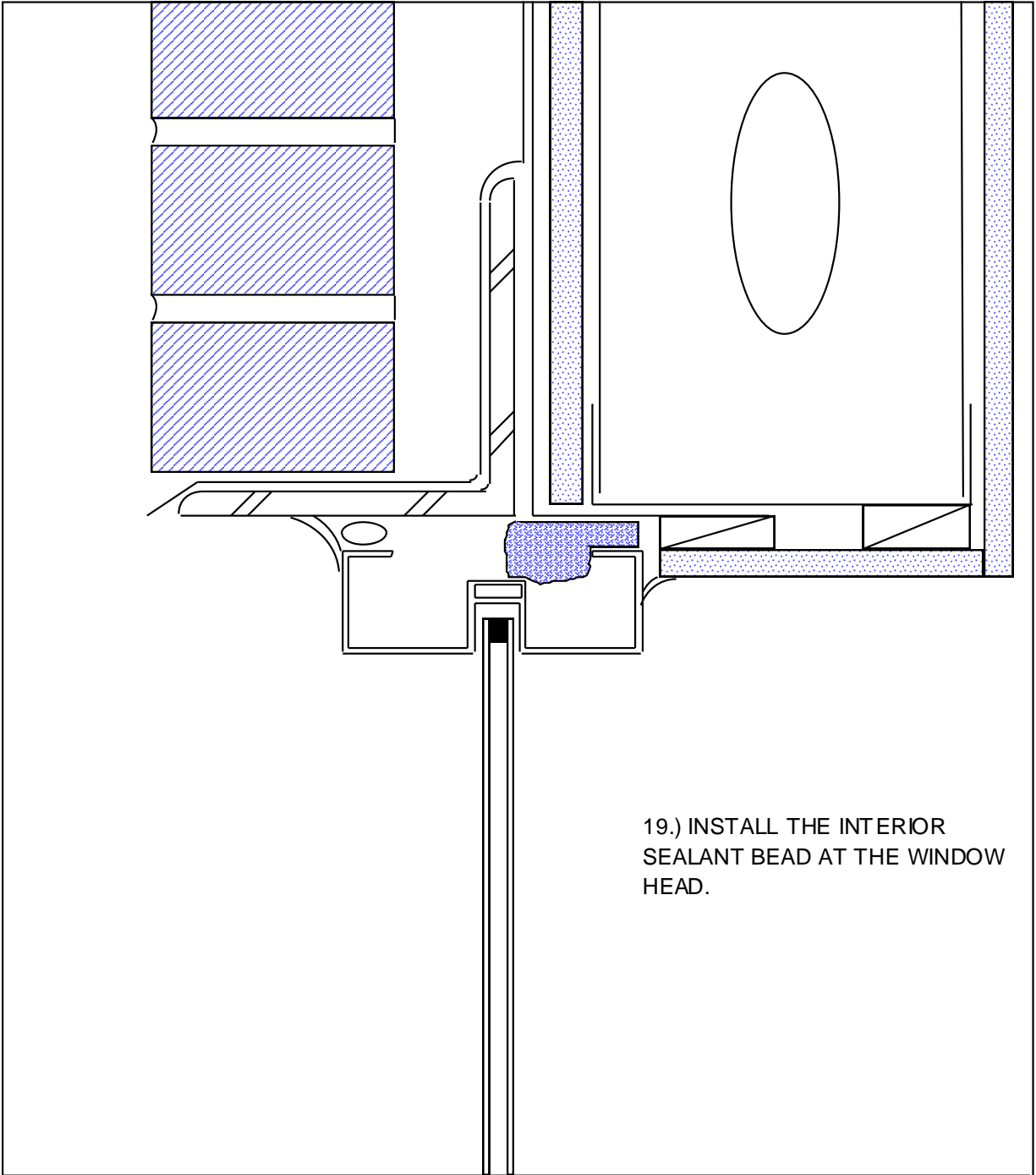

19.) INSTALL THE INTERIOR  
SEALANT BEAD AT THE WINDOW  
HEAD.

**EXO-TEC MANUFACTURING, INC.**

294 PLEASANT ST. SUITE 203A, STOUGHTON, MA 02072

( 781 ) 344-9794 FAX ( 781 ) 344-9823

[www.exo-tec.biz](http://www.exo-tec.biz)

WINDOW FLASHING SYSTEM INSTALLATION: STEP 19